

Fencing & Sectional Building Manufacturers

**Beach Huts
Tankerton**

Disability Adaptations

CCC-Tank-SK02 (Disability) Double doors/1.2m wide ramp

Additional supports/base for extra side (3.6m²),
pressure treated 100mmx100mm PAR newell posts on
100mmx47mm pressure treated
joists.....£1,300.00

Board in base/deck in horizontal loglap or shiplap with one
vertical tongue and groove, v-joint clad
door.....£575.00

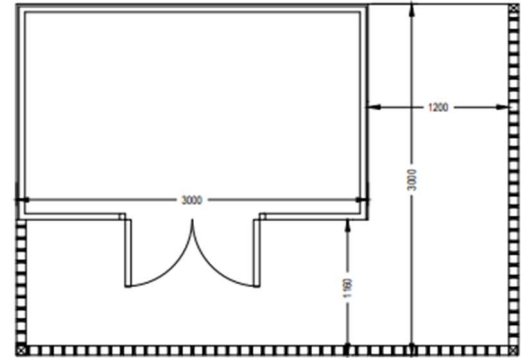

CCC-Tank-SK03 (Disability)

Additional supports/base for deck 3.6m²,
pressure treated 100mmx100mm PAR newell posts on
100mmx47mm pressure treated joists.....£1,300.00

Board in base/deck in horizontal loglap or shiplap with one
vertical tongue and groove, v-joint clad door.....£635.00
Some of these options/upgrades would require written permission
from Canterbury City Council Foreshore Services or the relevant
local authority.

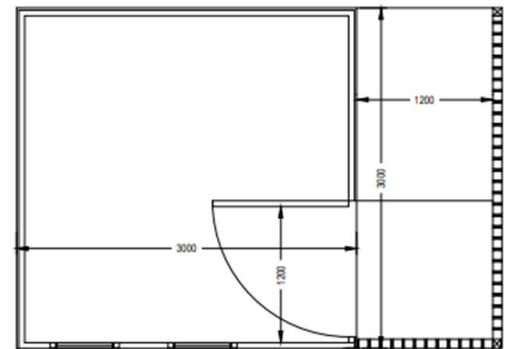

Options:

- Platform base 3.1mx3.1m (building): £765.00
- Additional door in base: £45.00
- 1160mm set steps: £250.00
- 1000mm set steps: £180.00
- Gate including padlock: £105.00
- Galvanised security bar kit :..... £290.00
- Single opening in window – opening out shutter unit: £310.00
- Double opening in window – opening out shutter unit: £455.00
- 2 no 760mmx610mm fixed windows with removable shutters: £180.00
(or free of charge if no windows/shutters used in doors)
- Bi-fold doors including centre post and 3 deadlocks: £1,150.00
- Modi torch-on felt (green): £400.00
- Whitewood horizontal cladding to walls and ceiling with 50mm fibreglass
cavity butts to walls and 70mm PIR board to ceiling. The floor will be
- 25mm PIR board covered with 12mm plyboard: £1,205.00
- 3 Key-alike locks (mortice dead lock):..... £175.00
- Clear old hut and base (no asbestos): £530.00
- Timber day bed with lift-up lid storage (approx 1700mmx550mm),
tongue and groove, v-joint front and plyboard top with tee hinges: £215.00
- Storage cupboards/worktops: POA