



Fencing & Sectional Building Manufacturers

Beach Huts
Tankerton



All prices include VAT

Specification:**Apex Height**

Apex 102" (2590mm)

Eaves 76" (1930)

Doors**Double**

Double framed, ledged and braced doors

52" x 70" (1345mm x 1780).

Stainless steel butt hinges, night

Latch, 2no hasp and staples to

Outside. Top glazed with timber shutters.

Single

Single framed, ledged and braced

(760mmx1780mm) with stainless steel butt

hinges, night latch and 2no dead locks

VerandahDeckboard smooth side up, PAR newell posts
and plain balustrade.**Cladding**Tongue and groove Shiplap $\frac{3}{4}$ " x 4"

(19mm x 100mm) OR Tongue and groove

Loglap 1" x 4" (25mm x 100mm)

FramingEased edge 1 $\frac{1}{2}$ " x 2" (38mm x 50mm)**Roofing felt**

20kg green polyester mineral felt

Floor22mm x 120mm pressure treated tongue
and groove timber**Floor joists**

2" x 4" (50mm x 100mm)

Lining

Black breathable membrane

Nails

Stainless steel

CCC-Tank-SK02 **£3,695.00**
 Board in base/deck in horizontal loglap or shiplap with one
 vertical tongue and groove, v-joint clad door: £440.00
 Platform base 3.1mx3.1m (building).....£845.00

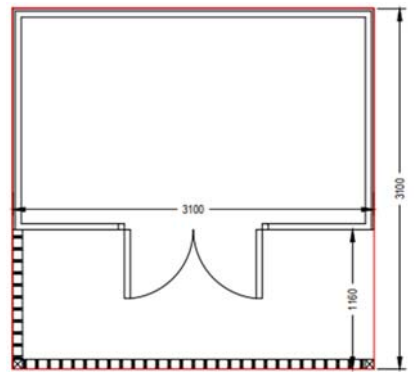

Decking/verandah options:

CCC-Tank-SK02A

Additional supports/base for extra front and side (5.3m²),
 pressure treated 100mmx100mm PAR newell posts on
 100mmx47mm pressure treated joists.....£2,110.00
 Board in base/deck in horizontal loglap or shiplap with one
 vertical tongue and groove, v-joint clad door.....£1090.00

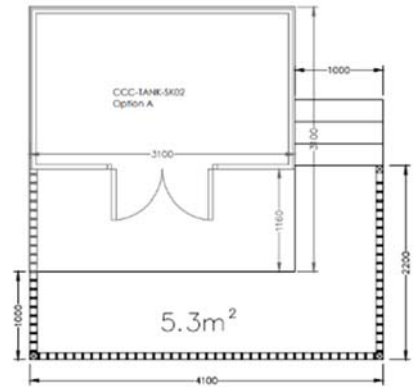

CCC-Tank-SK02B

Additional supports/base for extra 1.0m pulpit/steps,
 pressure treated 100mmx100mm PAR newell posts on
 100mmx47mm pressure treated joists.....£400.00

Board in base/deck in horizontal loglap or shiplap with one
 vertical tongue and groove, v-joint clad door.....£515.00

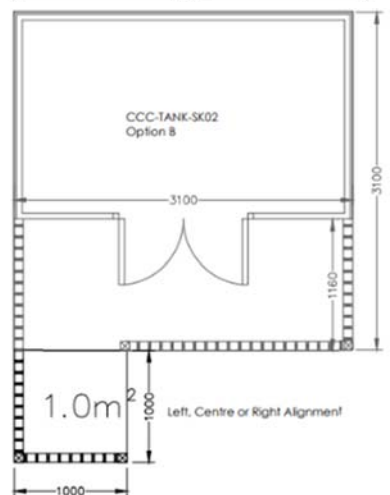

CCC-Tank-SK02C

Additional supports/base for deck 2.2m²,
 pressure treated 100mmx100mm PAR newell posts on
 100mmx47mm pressure treated joists.....£875.00

Board in base/deck in horizontal loglap or shiplap with one
 vertical tongue and groove, v-joint clad door.....£635.00

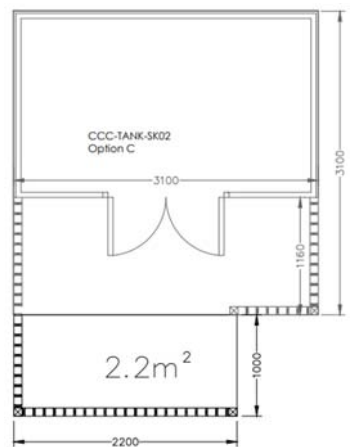

CCC-Tank-SK02D

Additional supports/base for deck 3.1m²,
 pressure treated 100mmx100mm PAR newell posts on
 100mmx47mm pressure treated joists.....£1,235.00

Board in base/deck in horizontal loglap or shiplap with one
 vertical tongue and groove, v-joint clad door.....£675.00

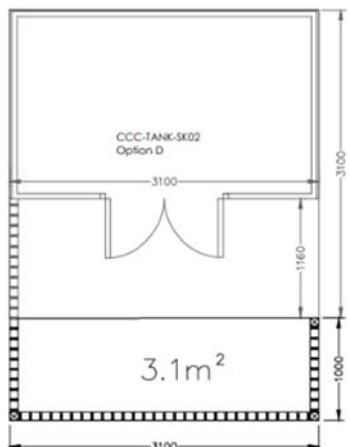

All prices include VAT

CCC-Tank-SK02E

Additional supports/base for deck 2.2m²,
pressure treated 100mmx100mm PAR newell posts on
100mmx47mm pressure treated joists.....£875.00

Board in base/deck in horizontal loglap or shiplap with one
vertical tongue and groove, v-joint clad door.....£635.00

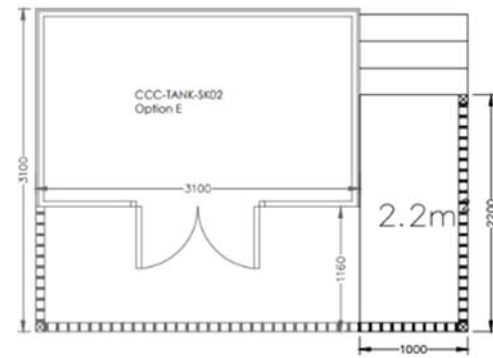

CCC-Tank-SK02F

Additional supports/base for deck 3.1m²,
pressure treated 100mmx100mm PAR newell posts on
100mmx47mm pressure treated joists.....£1,235.00

Board in base/deck in horizontal loglap or shiplap with one
vertical tongue and groove, v-joint clad door.....£675.00

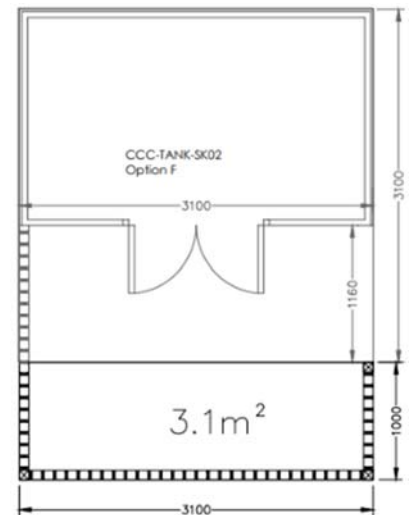

CCC-Tank-SK02G

Additional supports/base for deck 1.0m²,
pressure treated 100mmx100mm PAR newell posts on
100mmx47mm pressure treated joists.....£405.00

Board in base/deck in horizontal loglap or shiplap with one
vertical tongue and groove, v-joint clad door.....£570.00

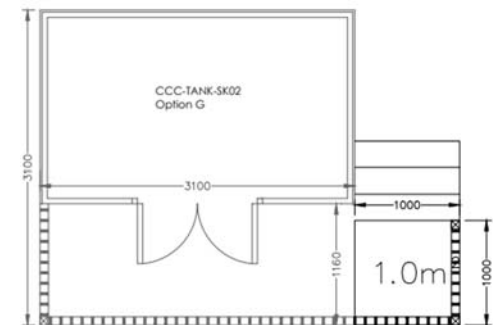

CCC-Tank-SK02 (Disability) Double doors/1.2m wide ramp

Additional supports/base for extra side (3.6m²),
pressure treated 100mmx100mm PAR newell posts on
100mmx47mm pressure treated joists.....£1,430.00

Board in base/deck in horizontal loglap or shiplap with one
vertical tongue and groove, v-joint clad door.....£635.00

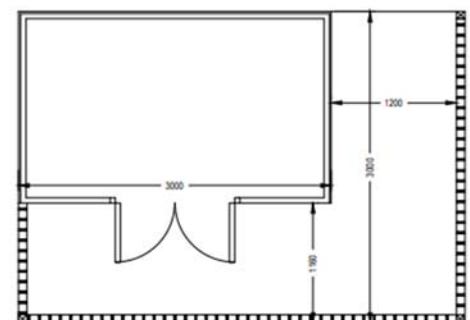

CCC-Tank-SK03.....£3,515.00

Board in base/deck in horizontal loglap or shiplap with one vertical tongue and groove, v-joint clad door.....£570.00

Platform base 3.1mx3.1m (building) £845.00

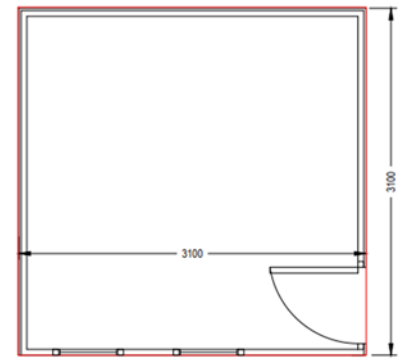

Decking/verandah options:

CCC-Tank-SK03A

Additional supports/base for deck 5.3m², pressure treated 100mmx100mm PAR newell posts on 100mmx47mm pressure treated joists.....£2110.00

Board in base/deck in horizontal loglap or shiplap with one vertical tongue and groove, v-joint clad door.....£790.00

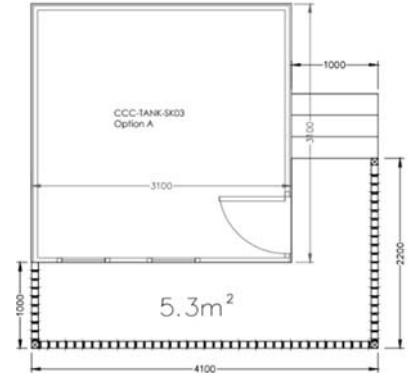

CCC-Tank-SK03B

Additional supports/base for deck 3.1m², pressure treated 100mmx100mm PAR newell posts on 100mmx47mm pressure treated joists.....£1,205.00

Board in base/deck in horizontal loglap or shiplap with one vertical tongue and groove, v-joint clad door.....£680.00

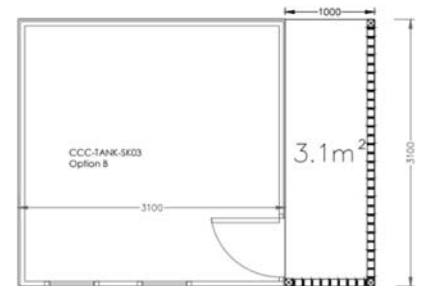

CCC-Tank-SK03C

Additional supports/base for deck 2.2m², pressure treated 100mmx100mm PAR newell posts on 100mmx47mm pressure treated joists.....£880.00

Board in base/deck in horizontal loglap or shiplap with one vertical tongue and groove, v-joint clad door.....£740.00

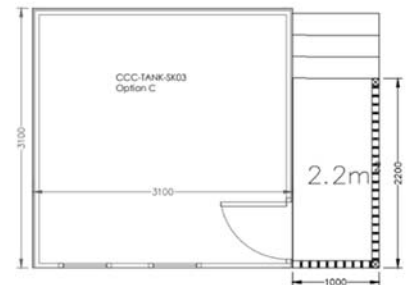

CCC-Tank-SK03D

Additional supports/base for deck 1.0m², pressure treated 100mmx100mm PAR newell posts on 100mmx47mm pressure treated joists.....£405.00

Board in base/deck in horizontal loglap or shiplap with one vertical tongue and groove, v-joint clad door.....£570.00

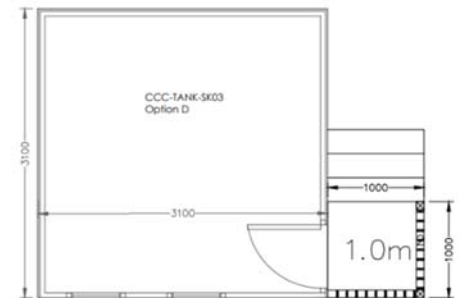

CCC-Tank-SK03 (Disability)

Additional supports/base for deck 3.6m², pressure treated 100mmx100mm PAR newell posts on 100mmx47mm pressure treated joists.....£1,430.00

Board in base/deck in horizontal loglap or shiplap with one vertical tongue and groove, v-joint clad door.....£700.00

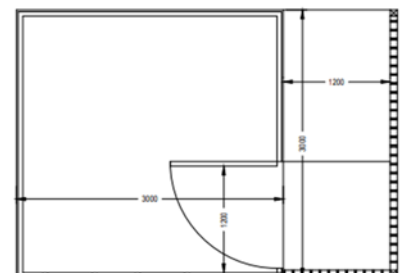

All prices include VAT

Options and Upgrades

Some of these options/upgrades would require written permission from Canterbury City Council Foreshore Services or the relevant local authority.

Platform base 3.1mx3.1m (building):	£845.00
Additional door in base:	£50.00
1160mm set steps:.....	£275.00
1000mm set steps:.....	£200.00
Gate including padlock:.....	£120.00
Galvanised security bar kit :	£320.00
Single opening in window – opening out shutter unit:.....	£345.00
Double opening in window – opening out shutter unit:	£500.00
2 no 760mmx610mm fixed windows with removable shutters:	£200.00
(or free of charge if no windows/shutters used in doors)	
Modi torch-on felt (green):.....	£450.00
Whitewood horizontal cladding to walls and ceiling with 50mm fibreglass cavity butts to walls and 70mm PIR board to ceiling. The floor will be 25mm PIR board covered with 12mm plyboard:	£1,325.00
3 Key-alike locks (mortice dead lock):	£195.00
Clear old hut and base (no asbestos):	£580.00
Timber day bed with lift-up lid storage (approx 1700mmx550mm), tongue and groove, v-joint front and plyboard top with tee hinges:	£240.00
Storage cupboards/worktops:	POA